

## Prophy Angle Head

**085-0321 AR-YS**

**085-0339 AR-YK**

 AUTOCLAVABLE

OPERATION MANUAL

OM-CK309E 004

### ! Caution before use

- The Patterson® prophy angle head is intended for use by dental professionals only.
- Read this operation manual carefully before using the prophy angle head.
- Be sure to follow all the operating instructions, including all cautions and warnings.
- Keep this Operation Manual for future reference.
- Consider primarily the safety of the patient and the operator when using the prophy angle head.

## 1. Specifications

Product number	085-0321 AR-YS 085-0339 AR-YK
Head Configuration	085-0321 AR-YS screw type 085-0339 AR-YK knob type (snap-on type)
Applicable contra angle sheath	043-4126 EC ISO E-type, 1:1 drive 043-2542 E4R ISO E-type, 4:1 speed reduction
Allowable max. speed	3,000rpm

## 2. Installation of Propy Angle head into Contra angle Sheath

The Patterson® prophy angle head must be used with the following Patterson contra angle sheath:

- If the motor is a 1:1 drive type, install the prophy angle head into 043-2542 E4R contra angle sheath ISO E-type 4:1 speed reduction.
  - If the motor is a 4:1 speed reduction type, install the prophy angle attachment into 043-4126 EC contra angle sheath ISO E-type 1:1 drive.
- Insert the transmission gear supplied with the prophy angle into the contra angle sheath as illustrated.
- Align the clutch of the prophy angle head with that of the contra angle sheath.
- Install the prophy angle head, turning the union nut counterclockwise.

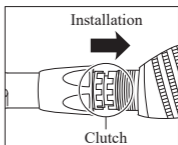

## 3. Installation of Propy Brush or Cup onto Propy Angle Head

### 085-0321 AR-YS screw type

- Insert the screw shank of the prophy brush or cup into a screw hole of the prophy angle head, and then turn the brush or cup in a clockwise direction to fix the screw shank.
- When removing the brush or rubber cup, turn it counterclockwise.

### 085-0339 AR-YK knob type (snap-on type)

- Holding the contra angle sheath connected onto the prophy angle head, fit the prophy brush or cup onto the knob of the prophy angle head.

### ! Caution

- Use a high quality prophy brush and prophy cup.
- Never use a prophy brush or rubber cup that cannot be installed smoothly onto the prophy angle head.

## 4. Operation

- Preset the rotation speed below 3,000rpm, and then make a test run to make sure that the prophy brush or cup is securely installed on the prophy angle head.

### ! Warning

- In case the screw type prophy brush or cup is installed on the 085-0321 AR-YS screw type prophy angle, preset a motor's rotating direction in a forward direction, and then make sure that the brush or cup rotates in a forward direction before use.
- Never rotate the screw type brush or cup in a reverse direction in oral cavity, as the screw-in cup or brush may be removed.

- Use the prophy angle head, setting the motor speed in optimum condition so the prophy paste does not spatter in oral cavity or the brush or cup does not hurt the tooth surface or gum.

### ! Caution

- Never use the prophy angle head when the screw type prophy brush or rubber cup rattles after it is installed on the 085-0321 AR-YS screw type prophy angle head.
- When abnormal vibration, noise, overheating, etc., occurs while the prophy angle head is in the test run or use, stop using the prophy angle immediately.

## 5. Cleaning and Drying

### Cleaning and Drying the Exterior

The use of automated cleaning devices is not recommended for the cleaning of Propy Angle Heads.

Wash the handpiece under running water following the procedures below. (Water condition:  $\leq 100^{\circ}\text{F}$ ,  $\geq 3.5\text{L}/\text{min}$ ; water should be of the same quality as drinking water)

- Clean the external surfaces of the handpiece with a soft bristled toothbrush for 15 seconds or more.

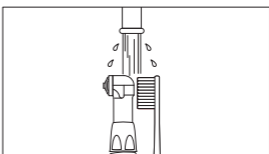

- Clean around the bur insertion hole for 15 seconds or more, using an interdental brush (wire thickness 0.7mm) that conforms to size 4 in ISO 16409.

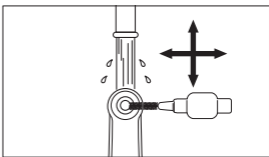

Under appropriate lighting

(natural office lighting, 500 lx or higher), inspect the handpiece for blood, paste or other debris. If any visible debris remains, repeat the process until the handpiece is visually clean.

After cleaning, if the residual moisture is present, wipe off with dry cloth or blow it off with compressed air ( $\leq 50.75$ psi) until there is no moisture in the interior and exterior.

When blowing off with compressed air, cover the handpiece with cloth to prevent scattering of water. Proceed to 6: Cleaning and Lubrication.

## 6. Cleaning and Lubrication

### Cleaning and Lubricating the Interior

- Attach an E-Type spray nozzle to the nozzle of the PANA SPRAY Plus.
- Shake the can 3 or 4 times and insert the E-Type spray nozzle into the rear of the handpiece while holding the head of the handpiece with a cloth etc.

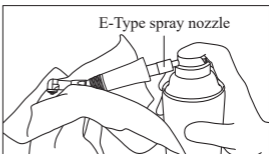

- Hold the handpiece and spray for 2 or 3 seconds until oil comes out of the handpiece head. Repeat lubrication until foreign material stops coming out of the tip.



### Caution

- Do not use sprays other than PANA SPRAY Plus. Using sprays other than PANA SPRAY Plus may cause the handpiece to overheat.
- Hold the spray can upright.
- Firmly hold the handpiece to prevent it slipping when spray pressure is applied.
- Spray lubricant until it expels from the handpiece head.

## 7. Sterilization

**Autoclave is recommended for sterilization.**

- Before sterilization, clean the surface of the prophy angle head and lubricate it. Refer to the instructions in 5: Cleaning and Drying and 6: Cleaning and Lubrication.
- Put the prophy angle head into a sterilization pouch by itself.
- Place the prophy angle head in the center or upper shelf of the autoclave chamber.
- Autoclave the prophy angle head at temperature up to  $275^{\circ}\text{F}/135^{\circ}\text{C}$  for 20 minutes.



### Caution

- Never use dry heat sterilization, cold sterilization, etc.
- Never autoclave the prophy angle head with other instruments in a sterilization pouch.
- Never place the prophy angle head at the bottom of autoclave chamber, as the temperature at the bottom may rise above the actual setting temperature.

## 8. Removal of End Cap and Gear Stem

**Use a service wrench provided with the prophy angle for the removal/ installation of the end cap.**

- Remove the end cap from the prophy angle, turning the wrench in a clockwise direction as indicated. The end cap is removed with the gear stem.
- Replace the end cap and the gear stem. (The end cap and the stem of the knob type are made in one piece.)
- Fix the back cap. Turn the back cap with fingers in a counterclockwise direction and use the wrench to fix it securely.
- Lubricate the prophy angle, and then make a running test. Refer to 6. Cleaning and Lubrication.

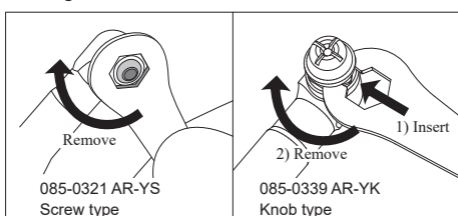

## 9. Guarantee

Patterson guarantees the prophy angle head against poor workmanship and defect in materials used. Patterson reserves the right to analyze and determine the cause of any failure. Guarantee is void if the breakage, accident or any other issues are caused by the neglect of the daily maintenance, cautions, warnings and common sense in use. Dismantling or reassembling by any third parties other than the Patterson National Technical Services except the replacement of the back cap and the gear stem, voids guarantee.

## 10. Symbol



This product can be sterilized in a steam sterilizer at  $135^{\circ}\text{C}$ .



HIBCC DataMatrix for Unique Device Identifier.

*Pour une version en français du manuel d'utilisation, veuillez vous rendre sur le site Web de Patterson:*  
<https://www.pattersondental.com/fr-CA>

Manufactured for:

Fabriqué pour :

Patterson Dental Supply, Inc.  
 1031 Mendota Heights Road  
 Saint Paul, MN 55120

2022-11-24 CACCXXXX XXN